

REPORT TITLE: GEORGIAN WEST ESSA BASE BORDEN  
PUPIL ACCOMMODATION REVIEW - RECOMMENDATIONS  
REPORT NUMBER: Appendix 4 to Report 8.1 (11-2010)  
DESTINATION: Board Meeting # 11  
DATE: Wednesday, June 23, 2010  
AUTHOR OF REPORT: Michael O'Keefe, Director of Education  
TYPE OF REPORT: ACTION

## AGENDA

(PAC) WORKING GROUP FOLLOW-UP MEETING  
Our Lady of Grace Catholic School  
Monday June 7, 2010 ~ 7 p.m.

---

1. WELCOME
  
  2. OPENING PRAYER: *'Blessing Before a Meeting'*
  
  3. POWER POINT PRESENTATION
  
  4. CONCLUDING REMARKS
  
  5. CLOSING PRAYER: *'Our Father'*
  
  6. ADJOURNMENT
-

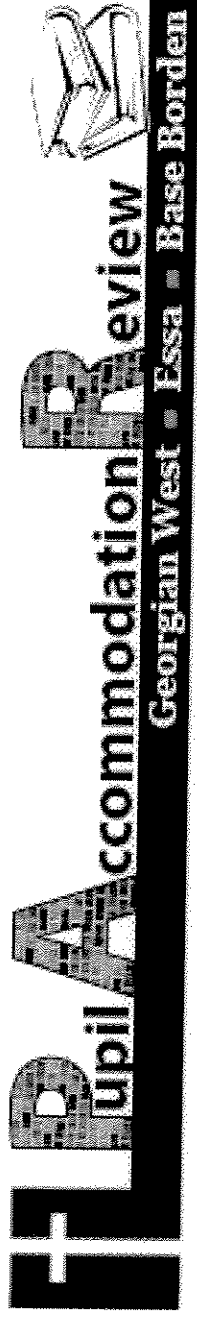

# **Pupil Accommodation Committee (PAC)**

## **Working Group**

### **Follow-Up Meeting**

- ◆ **To provide the Georgian West Essa Base Borden area Pupil Accommodation Committee with an information and process update**

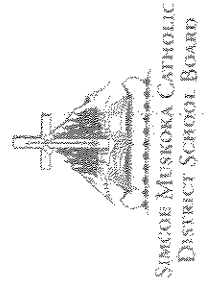

*Growing Community with Truth, Compassion & Service...*  
*June 7, 2010*

# **EP**upil **Accommodation Review** Georgian West • Essa • Base Borden

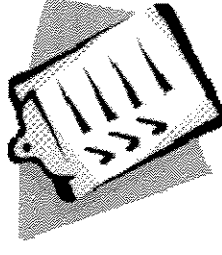

- 1. Overview**
- 2. PAC & Staff Recommendations**
- 3. Staff Report – Purpose and Analysis**
- 4. Alternative Site Options for OLA**
- 5. Site Design Concepts for OLG addition**
- 6. Funding Information**
- 7. Next Steps**

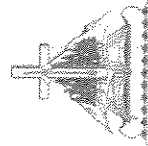

# **EPRA** **Upil Accommodation Review**

Georgian West • Essa • Base Horden



- 1. Overview:**  
**To provide:**
  - **Update on the process**
  - **PAC's Role ends once the PAC Report is submitted to the Director;**
  - **opportunity for further dialogue with the PAC;**
  - **any new information from the PAC will be shared with the Trustees through minutes of this meeting which will be attached to the final report to the Board of Trustees;**

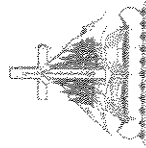

## 1. Overview (cont'd):

### To provide:

- Update on the process
- any members of the public are observers to this meeting;
- Staff's Role is resource to the PAC & author of reports that consider the PAC Report and all other factual information

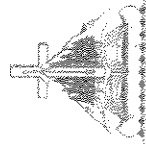

## 1. Overview (cont'd):

To provide:

- any new updated information
- further analysis & review of recommendations
- budgetary implications
- an understanding of the next steps

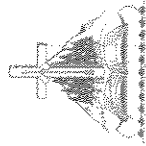



## 2. PAC Recommendations: OPTION 1

•**ST. NOEL CHABANEL (SNC) & ST. MARY'S (SMC)**

Status Quo for the school building and school community.

•**PRINCE OF PEACE (POP)**

Status Quo for the school building and school community.

*(facility retrofit items to be addressed through the Board's routine budget process or other funding sources)*

•**OUR LADY OF GRACE (OLG)**

School to receive an addition to replace the Prohibitive to Repair (PTR) portion of the school. School to be designed and constructed to accommodate more than existing pupil places.

•**OUR LADY OF THE ASSUMPTION (OLA)**

Replace the school on a new site within the Township of Clearview. School to be designed and constructed to accommodate the existing school community.

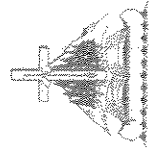

## 2. PAC Recommendations (cont'd): OPTION 2

- **ST. NOEL CHABANEL (SNC) & ST. MARY'S (SMC)**  
Status Quo for the school building and school community.
- **PRINCE OF PEACE (POP)**  
Status Quo for the school building and school community.  
*(facility retrofit items to be addressed through the Board's routine budget process or other funding sources)*
- **OUR LADY OF GRACE (OLG)**  
Our Lady of Grace to receive an addition to the school to replace the Prohibitive to Repair (PTR) portion of the school. School to be designed and constructed to accommodate more than existing pupil places.
- **OUR LADY OF THE ASSUMPTION (OLA)**  
Close Our Lady of the Assumption school building with the existing OLA students moving to other review area schools depending on decisions made during the boundary review process. Students would remain at OLA until the replacement project is built at OLG.



## 2. PAC Recommendations (cont'd):

#	Option	# of Votes
Option 1	New Site for OLA	7
Option 2	Close OLA & consolidate w/OLG with addition	13

- Total of 20 attendees at the last working group meeting



## 2. Staff Recommendations:

### •ST. NOEL CHABANEL & ST. MARY'S

Status Quo for the school building and school community; and

### •OUR LADY OF GRACE

Construct an addition to Our Lady of Grace Catholic school on the existing site to replace the Prohibitive to Repair portion of the school. The addition to the school to be designed and constructed to accommodate more than existing pupil places; and

### •OUR LADY OF THE ASSUMPTION

Close Our Lady of the Assumption Catholic school once the Our Lady of Grace Catholic school renovation is complete. All OLA students will move to the new facility at this time; and

### •PRINCE OF PEACE

To close Prince of Peace Catholic school once the Our Lady of Grace Catholic school renovation is complete. All POP students to move to the new facility at this time.

- *All recommendations are subject to available Ministry of Education capital funding.*

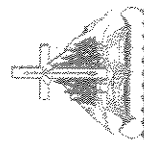



### 3. Staff Report - Purpose:

- provide fiscally responsible representation
- offer all pertinent factual information
- provide analysis and recommendation

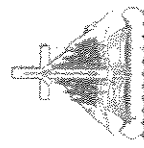
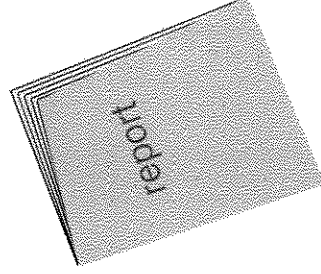

### 3. Staff Report - Analysis:

#### Our Lady of the Assumption

1. Building & Property Condition
2. Program
3. Small School Funding Opportunities & challenges

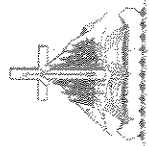

### 3. Staff Report – Analysis:

#### Prince of Peace

1. Building & Property Condition
2. Enrolment / Capacity  
(catchment area versus pupil distribution)

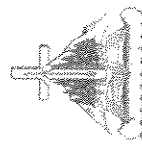

#### **4. Alternative Site Options for OLA:**

- **Receiving input from local Real Estate**
- **Parameters for review of alternative site**
  - within Clearview Township
  - Minimum 5 acre rectangular site
  - available municipal services
  - Consideration and compliance with the SMCDSB Site Acquisition Policy
- **Alternative Site Information**
  - Once received we anticipate including this information in the Report to Board on June 23, 2010

Note: To support the ongoing PAR process additional research on alternative sites in Clearview Township is being done.

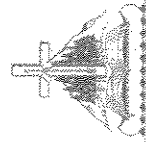

## 5. Site & Building Design Concepts:

# OUR LADY OF GRACE ADDITION

Note: To support the ongoing PAR process additional research is being completed on site and building design concepts for an addition at Our Lady of Grace.

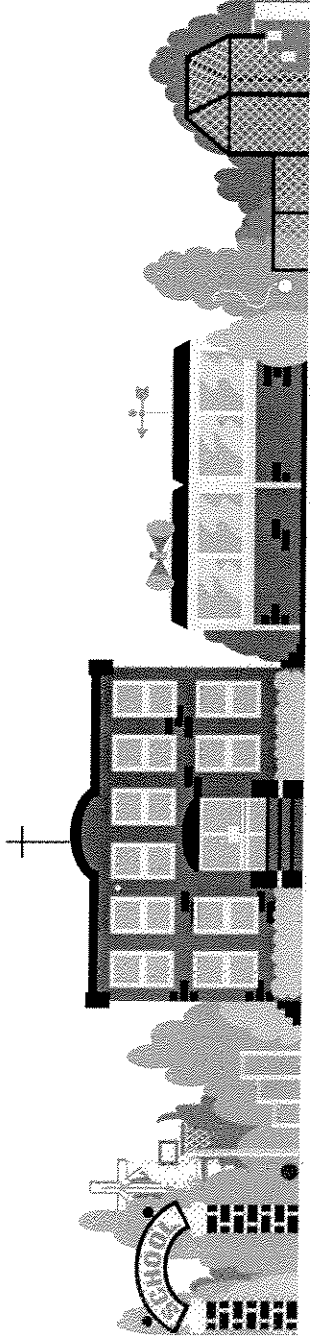

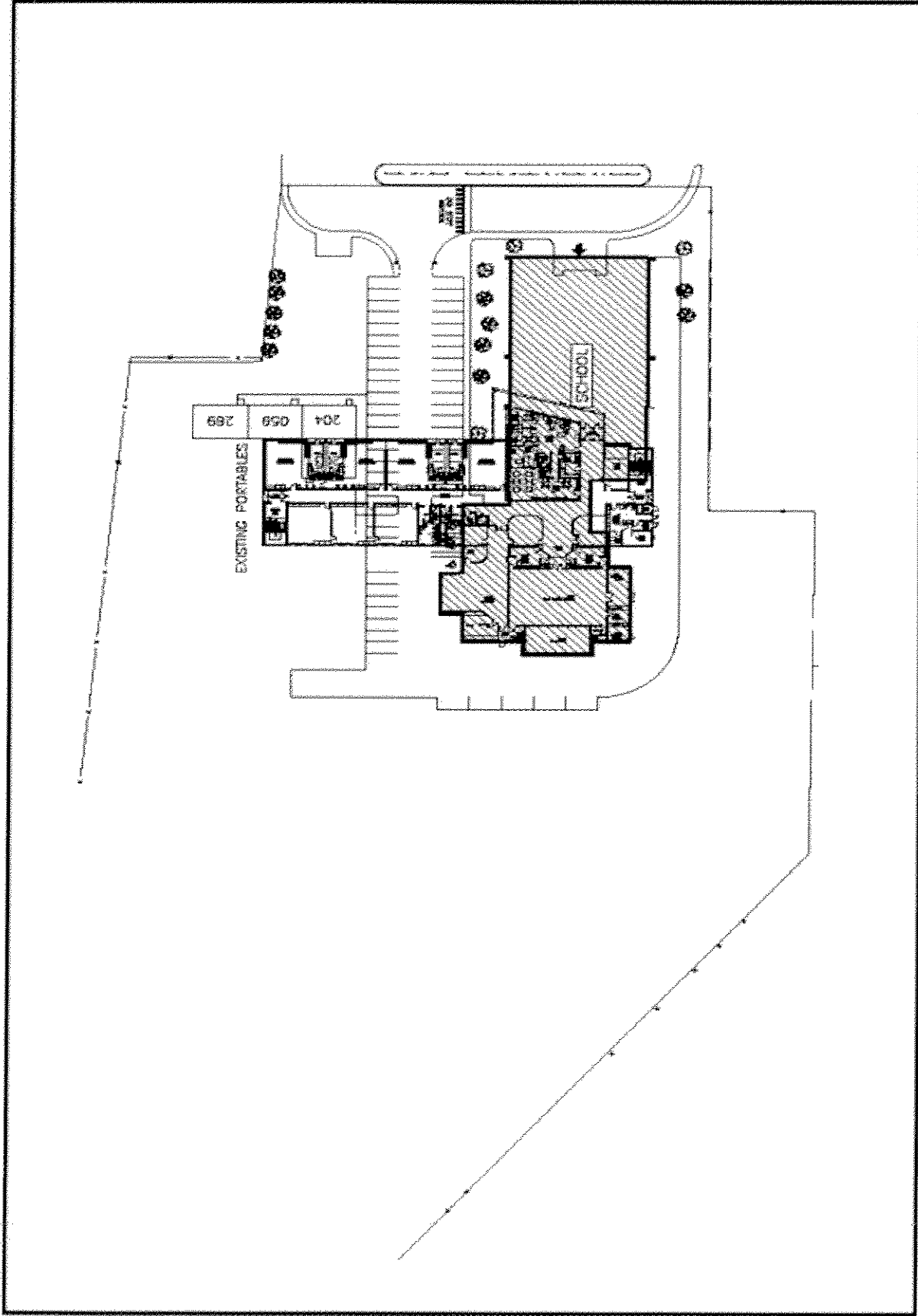

**OUR LADY OF GRACE CATHOLIC SCHOOL**  
**SITE PLAN - EXISTING**



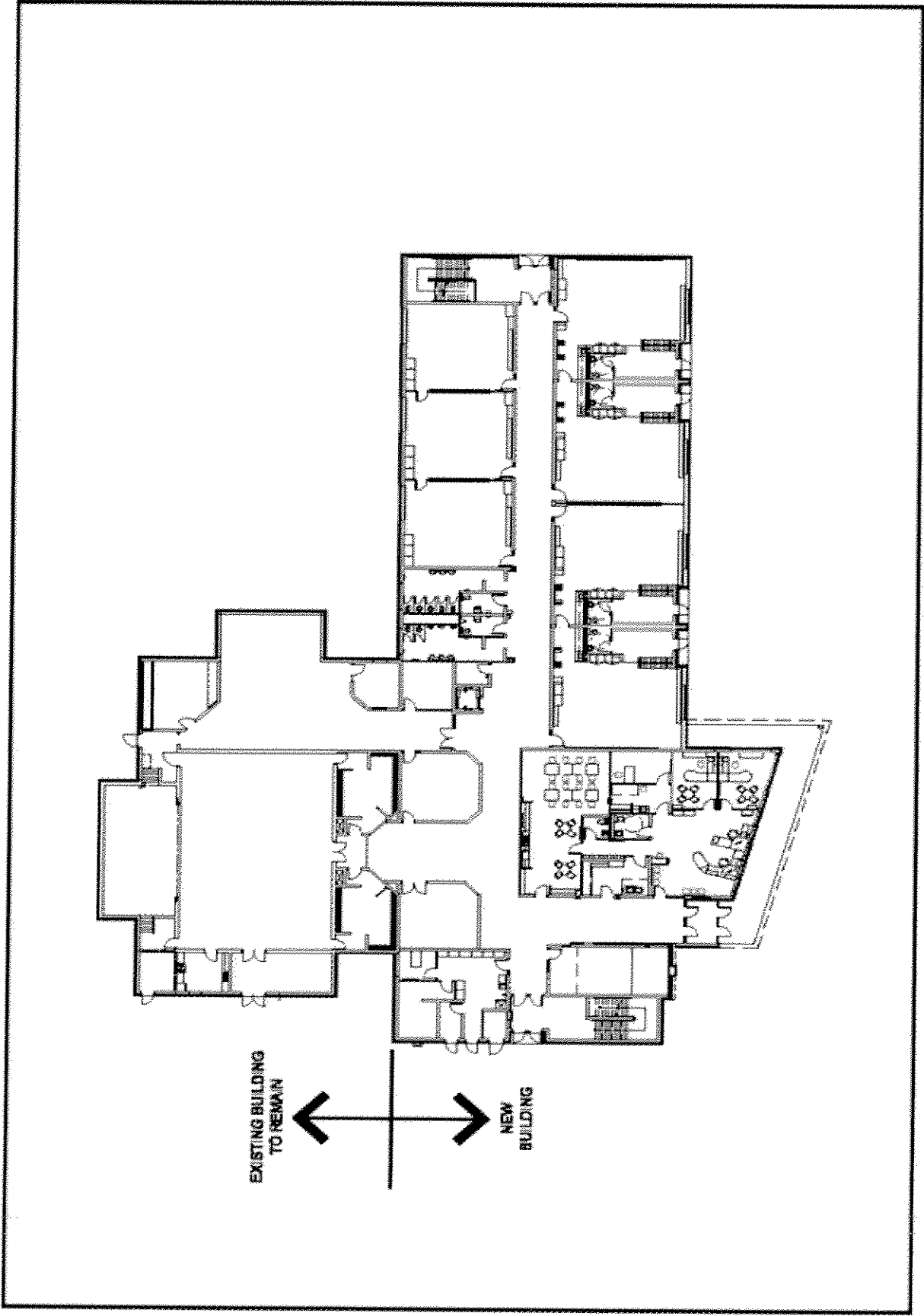

**OUR LADY OF GRACE CATHOLIC SCHOOL**

**FIRST FLOOR PLAN**

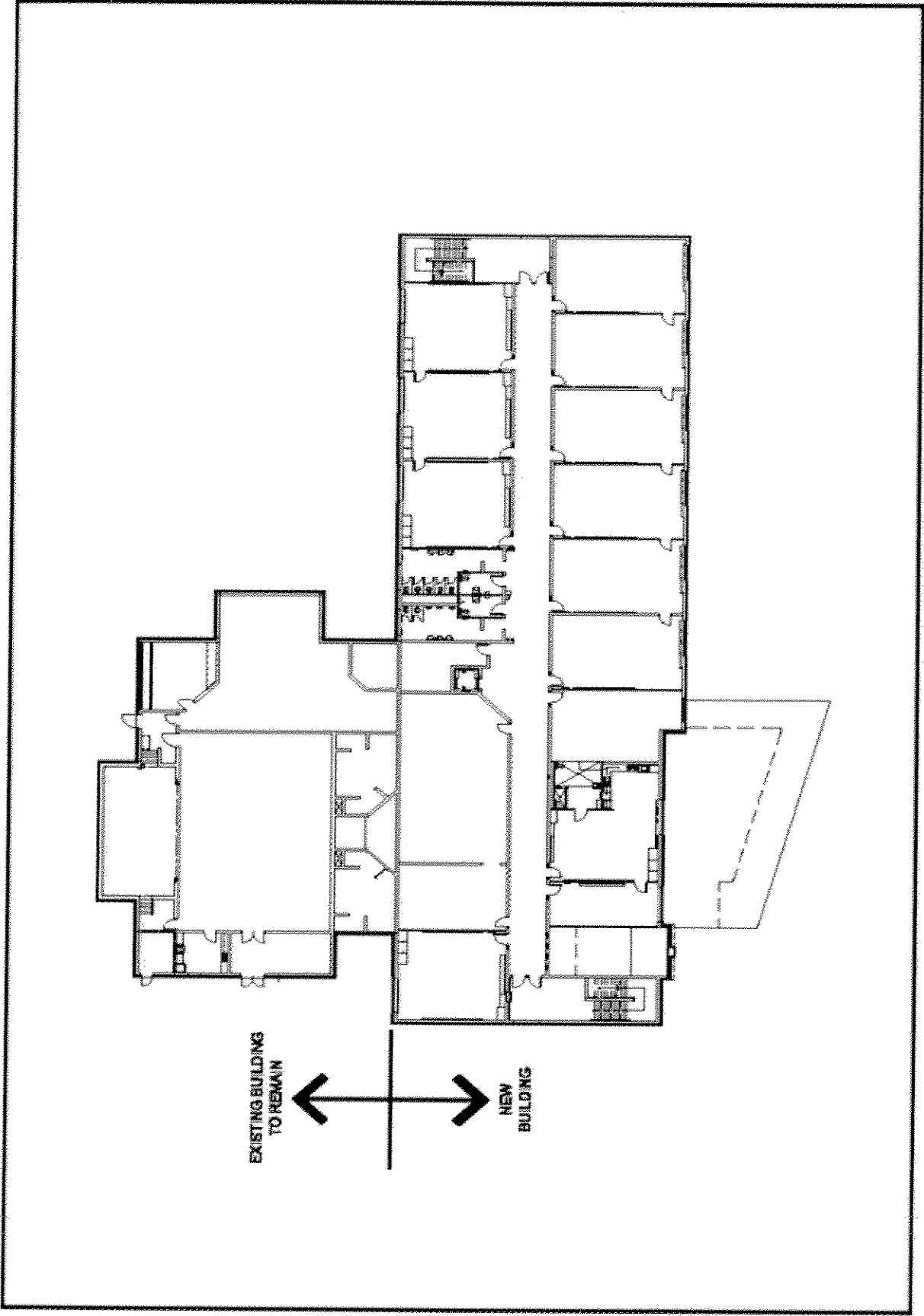

**OUR LADY OF GRACE CATHOLIC SCHOOL**  
**SECOND FLOOR PLAN**

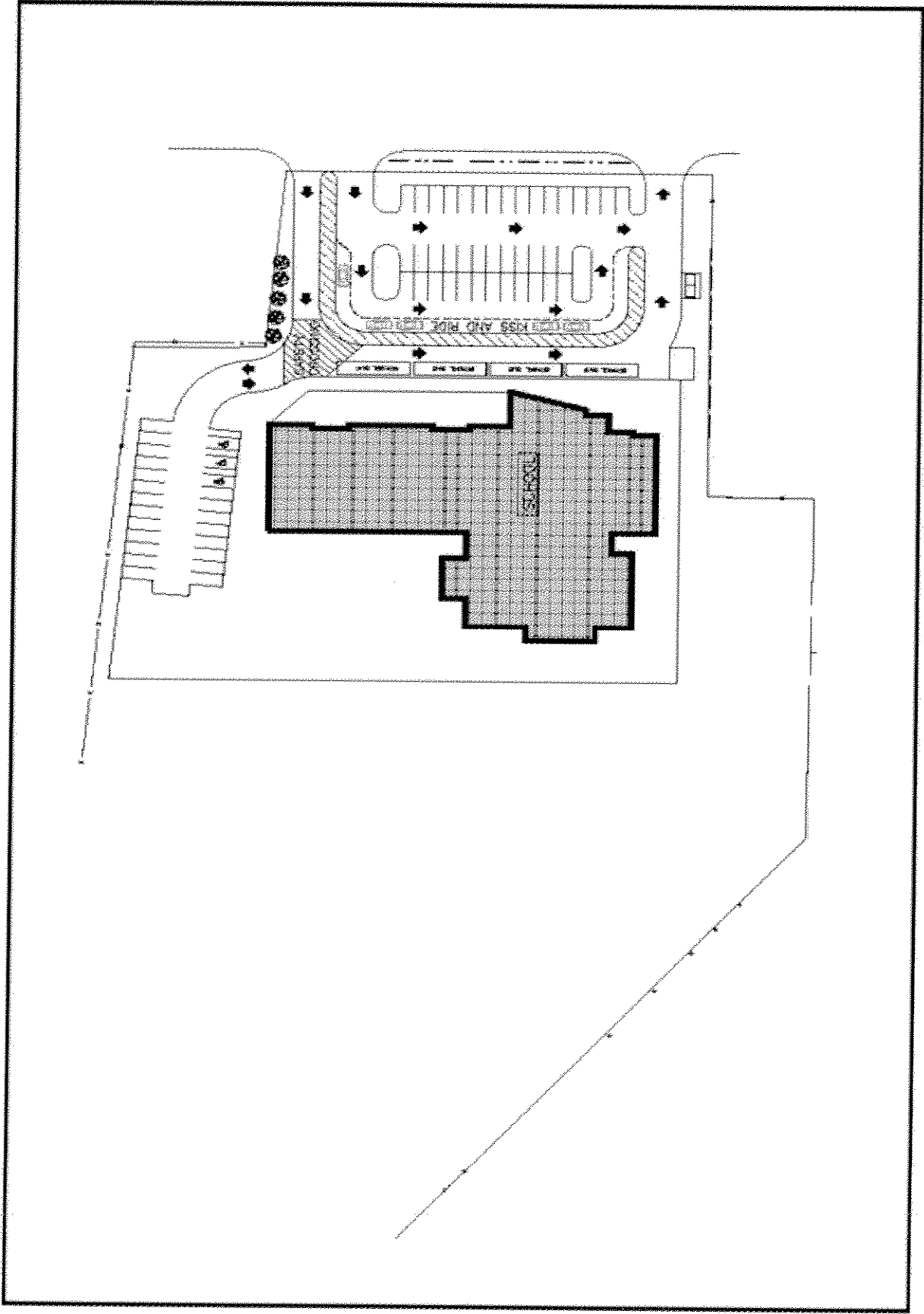

**OUR LADY OF GRACE CATHOLIC SCHOOL**  
**SITE PLAN - PROPOSED**

## 6. Funding Information:

- Ministry of Education Update
  - 181 Accommodation Review completed since 2006
  - 20 administrative reviews requested
  - 1 appeal accepted by Ministry as acceptable.

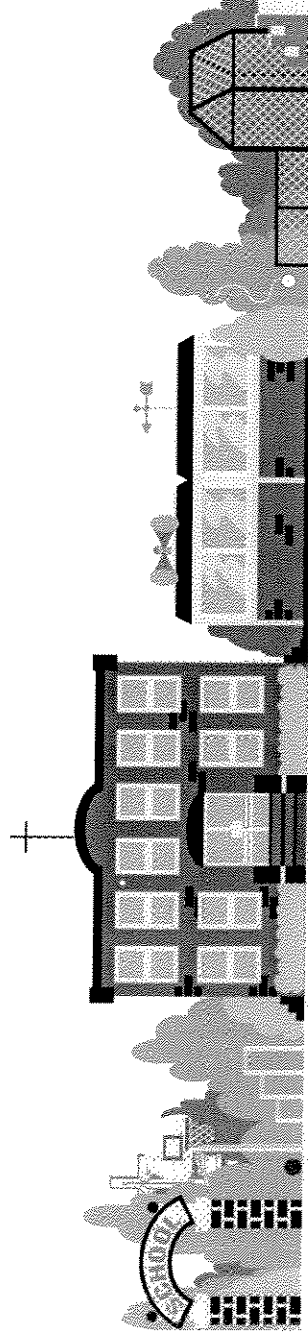

**7. Next Steps:**

✓ Minutes from tonight's meeting to be attached to final Report to Trustees on June 23, 2010.

✓ June 23, 2010  
Board to Consider Decision on School Accommodation

✓ June 24, 2010  
Notice of Decision to affected school communities

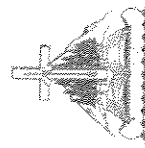

# CLOSING PRAYER

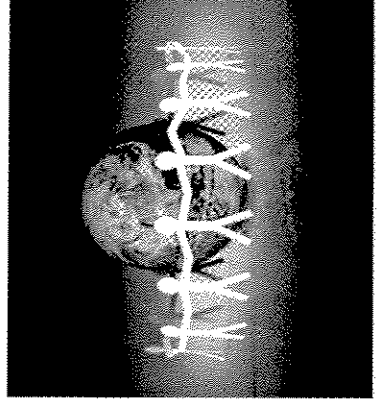
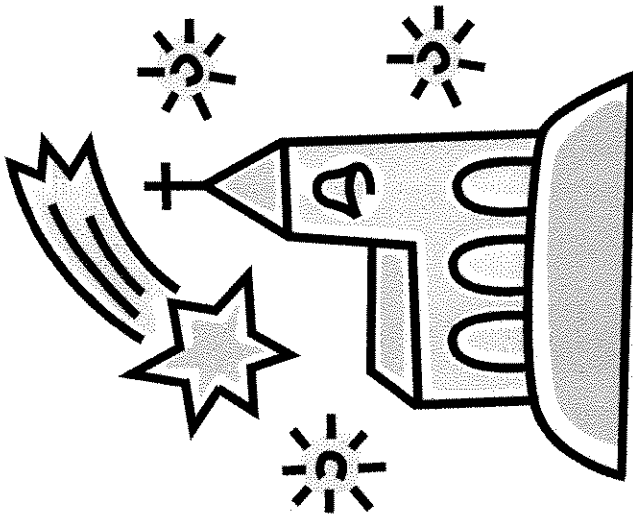

## MINUTES OF MEETING

### PUPIL ACCOMMODATION REVIEW (PAR) PAC WORKING GROUP FOLLOW- UP MEETING

---

To: Jennifer Sharpe, Glenn Clarke, Kristin Dibble Pechkovsky

Date: June 7, 2010 at OUR LADY OF GRACE (7 p.m.)

Re: GEORGIAN WEST~ ESSA - BASE BORDEN PUPIL ACCOMMODATION REVIEW, 2009/2010

---

1. **WELCOME/INTRODUCTIONS:**

Jane Dillon-Leitch, Superintendent of Schools and Glenn Clarke, Controller of Plant, welcomed the (PAC) Committee and the Public attendees and outlined the purpose of the meeting at 7:00 p.m.

2. **OPENING PRAYER:** 'Blessing Before a Meeting' prayer was led by Clayton Ferguson; SMCDSB Trustee and was said by all.

3. **POWER POINT PRESENTATION:** A PowerPoint presentation was given to the Georgian West Pupil Accommodation Committee (PAC). Hardcopies of the presentation were available as handouts and can be found on the Board website at [www.smcdsb.on.ca](http://www.smcdsb.on.ca) under Community/Pupil Accommodation.

Jane Dillon Leitch, Superintendent of Schools provided an overview of tonight's PAC meeting along with the PAC Recommendations to the Pupil Accommodation Review Committee.

Glenn Clarke, Controller of Plant reviewed the following information:

- ❖ Staff Recommendations and key areas for each of the schools.
- ❖ Staff Report – Purpose and Analysis
- ❖ Alternative Site Options for Our Lady of the Assumption Catholic School
- ❖ Preliminary Site Design Concepts for OLG addition
- ❖ Funding Information

4. **QUESTION/COMMENTS:**

**Question: Margriet Kempers, OLA**

Why was the vote for recommendations not extended to all of the PAC members? Everyone was not given a fair opportunity to vote. I could not attend as I was working and I think my vote should have been considered. I would have sent my vote in by mail or by computer.

**Answer: Glenn Clarke, Controller of Plant**

The vote was to provide an indication; it was used for information purposes only.

**Question: Margriet Kempers, OLA**

The process should involve the entire community to give us a voice. You are pitting the communities against each other.

**Answer: Glenn Clarke, Controller of Plant**

It is up to the Trustees to see and hear your concerns. I think this has been a team effort.

**Answer: Jennifer Sharpe; Manager of Planning and Properties**

The Ministry doesn't specifically look at these reports. Early in the process we talked about the role of the PAC members and the participation at the meeting level. It was made clear whoever was in attendance would make the decisions. This vote was just an indicator through the process.

**Comment: Jennifer Robertson, OLG**

The two options went forward regardless of the voting numbers.

**Comment: Mike Dufort, SMC**

This meeting and vote was just about hearing what we had to say.

**Answer: Glenn Clarke, Controller of Plant**

The four School Valuations were really the key components in the process. We wanted to have open dialogue on everything so we could see the big picture.

**Question: Margriet Kempers, OLA**

How long has it been since you've received feedback from a real estate agent? Why are you looking at a new site if there isn't any funding available?

**Answer: Glenn Clarke, Controller of Plant**

We have been in contact with Remax Realty within the last week. Through the process we need to look at new sites. The PAC requested that the Board review new site options for OLA, therefore, we have initiated this process despite current funding availability.

**Question: Mike Dufort, SMC**

What is the purpose of the internal doors between the classrooms in the drawings?

**Answer: Jane Dillon-Leitch, Superintendent of Schools**

The doors facilitate supervision. They are used so that the kids can be easily supervised.

**Question: Margriet Kempers, OLA**

In regards to the larger second story building have you contacted the conservation authority about building a two storey facility?

**Answer: Glenn Clarke, Controller of Plant**

These drawings are just conceptual rough drawings. They are all contingent upon Municipal approvals, funding from the Ministry, including conservation authority, if applicable, etc.. We would need to have dialogue with the community before going forward.

**Question: Kevin Kuiak, POP**

How many busses would this proposed site plan accommodate? Is the parking area sufficient?

**Answer: Jennifer Sharpe, Manager of Planning and Properties**

We have had dialogue with transportation regarding the site plan and the drawing shows the average number of buses required. (4)

**Question: Mary Anne Gough, Business Rep. Wasaga Beach Community**

How would the students be accommodated during the renovation process?

**Answer: Glenn Clarke, Controller of Plant**

Considering the impact of construction, the students would need to be accommodated elsewhere, perhaps at Prince of Peace. We would need to have dialogue with the school community.

**Question: Theresa Skinner, POP**

So are Option #1 and Option #2 still being presented or are they dead in the water?



**Answer: Glenn Clarke, Controller of Plant**

These options are still alive and are being presented to the Trustees.

**Question: Margriet Kempers, OLA**

What other concepts are you presenting to us? Do you have other options to show us? Where is the investment in the other options? Who is your real estate agent? I could have a real estate agent find land for you.

**Answer: Glenn Clarke, Controller of Plant**

If you have any sites available please let us know. We are dealing with Remax Realty. In regards to POP we have had dialogue with the French board about the immediate repairs needed. It is not viable to build a new school for OLA. The plans we have presented for OLG are rough, preliminary concepts that were drawn up by our in-house staff.

**Question: Margriet Kempers, OLA**

I feel my time has been wasted and this is just the Board's perspective.

**Answer: Glenn Clarke, Controller of Plant**

Yes, the Staff report is from the Board's perspective. All of the PAC information has also been shared with the Board.

**Answer: Kevin Kuiak, POP**

The Board Staff writes the Staff Report and we are very lucky to have had the Trustees sit in with our Committee and hear our point of view. The Staff report is distinct and separate from the emotional piece. The Trustees can take back all the information with them to present to the other Trustees and then base their decision on these two sides.

**Question: Kevin Kuiak, POP**

Based on the current financial situation, what if the Government says no to money for OLG renovations? Would the Board put the request in for future request?

**Answer: Jennifer Sharpe, Manager of Planning and Properties**

Yes, from a Capital perspective, we routinely review our capital needs with the Trustees (approximately annually). We have ongoing communication with the Ministry. Ministry Staff have said we can submit a proposal at anytime for their review.

**Question: Martin Mazza, SMC**

Would it be problematic that the Staff Report and PAC Report are different?  
I am sure they would have favoured a more similar Staff and PAC Report.

**Answer: Teresa Pinder, SMCD SB Trustee**

There has been a lot of work on both sides and there are too many possibilities right now. The process is so complicated and we are limited to the changes we can make. I personally wasn't comfortable after the final meeting and I think we may have needed more meetings. The Trustees will review all of the work and we know this review has been very emotional to many people.

**Answer: Clayton Ferguson, SMCD SB Trustee**





The Trustees may even choose not to accept any of the recommendations because they may not like the gap between the two reports and then nothing would happen.

5. **CLOSING REMARKS:** Jane Dillon-Leitch, Superintendent of Schools thanked the (PAC) along with the SMCD SB Trustees for their time, commitment and the many hours spent participating in this process.
6. **CLOSING PRAYER:** Teresa Pinder, SMCD SB Trustee led the (PAC) in a closing prayer, "Our Father".
7. **ADJOURNMENT:** The meeting adjourned at 8:00 p.m.

Georgian West Essa Base B Open Pupil Accommodation Review

SIGN-IN SHEET

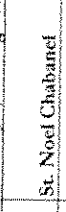
PAC FOLLOW-UP MEETING JUNE 7, 2010

First Name	Last Name	Title	School	Signature
Lori	Murray	Non Teaching Rep.	St. Mary's, Collingwood	
Miriam	Blasko	Principal	St. Noel Chabanel	
Deanna	Langan	Parent	St. Noel Chabanel	
Ingrid	DeJangh - MacDonald	Parent	St. Noel Chabanel	
Jennifer	Patent	Teacher Rep.	St. Noel Chabanel	
Ivana	Higgins	Non Teaching Rep.	St. Noel Chabanel	
Rhonda	Robert	Parish Rep	Our Lady of Grace	
Edna	Turcotte	Parish Rep	Prince of Peace	
Cindy	Robinson	Parish Rep	Our Lady of the Assumption	
Mary Anne	Gough	Business Rep	Wasaga Beach community	
Roger	McGillvray	Councillor	Clearview Township	
Norman	Ruttie	Lieutenant Colonel	Base Borden	
Connie	Gray	Councillor	Town of Wasaga Beach	
Clayton	Ferguson	School Trustee	SMCDSB	
Theresa	Pinder	School Trustee	SMCDSB	✓
Jane	Dillon-Leitch	Superintendent of Schools	SMCDSB	✓
Darren	Schmidt	Superintendent of Schools	SMCDSB	✓
Glenn	Clarke	Controller of Plant	SMCDSB	✓
Jennifer	Sharpe	Manager of Planning and Properties	SMCDSB	✓
Kristin	Dibble Pechkovsky	Planning Officer	SMCDSB	✓
Steve	Charbonneau	Assistant to the Superintendent	SMCDSB	



PAC FOLLOW-UP MEETING  
JUNE 7TH, 2010

# PUBLIC SIGN-IN SHEET

<u>NAME</u>	<u>LAST NAME</u>	<u>SCHOOL</u>	<u>SIGNATURE</u>
RIE	PATTON	OUR LADY OF THE ASSUMPTION	Oliver Njani Patton
ATT	WINDATT	"	Wa Winda